

**Top View**

- Notes:**
- ° 5,000 PSI Concrete
  - ° Reinforced with #6 Bars @ 12" O.C.E.W.
  - ° Security Door By GC. - Special Hinge & Latch System for FEMA Rating
  - ° All Exterior Joints Caulked
- Finishes:**
- ° Plain Gray
- Surface Finishes:**
- ° Smooth Form Finish

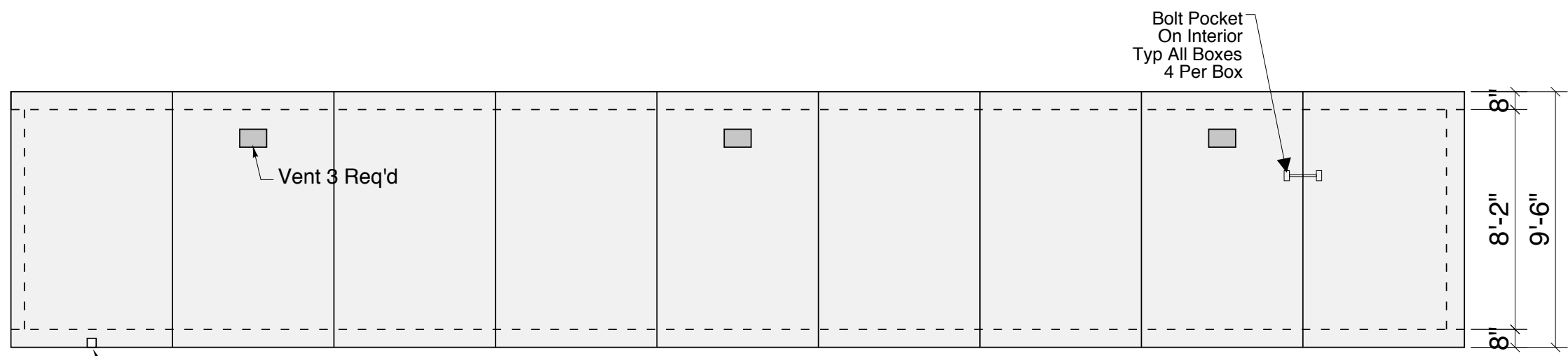

**Front View**

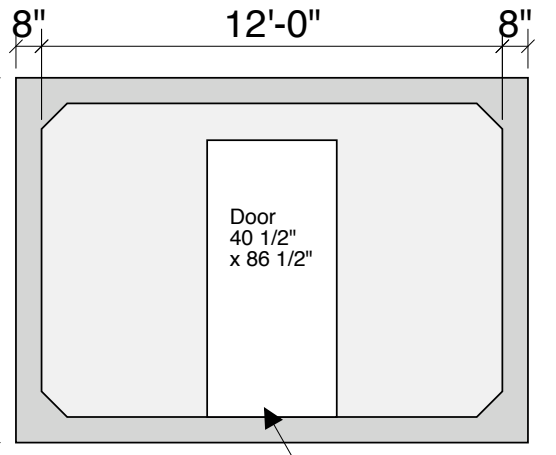

**End View**

**Storm Shelter For Caterpillar**

*Crest Precast, Inc.  
La Crescent, MN & Barneveld, WI*